

# ULTRAFLEX SA 5000

## DESCRIPTION

HIGH PERFORMANCE SELF-ADHESIVE RUBBER BITUMEN MEMBRANE ULTRAFLEX SA 5000 IS DESIGNED FOR INDOOR WATERPROOFING, WATERPROOFING OF FOUNDATIONS, ENGINEERING STRUCTURES, TERRACES AND NON-EXPOSED ROOF DECKS. IN FACT, THE SPECIAL COMPOUND BITUMINOUS ADHESIVE ENSURES LAYING OF STRUCTURES WHERE IT IS DANGEROUS OR PROHIBITED THE USE OF THE FLAME (EXPANDED / EXTRUDED POLYSTYRENE OR WOODEN BASE).

## APPLICATIONS

### FOUNDATION WITH THERMAL INSULATION

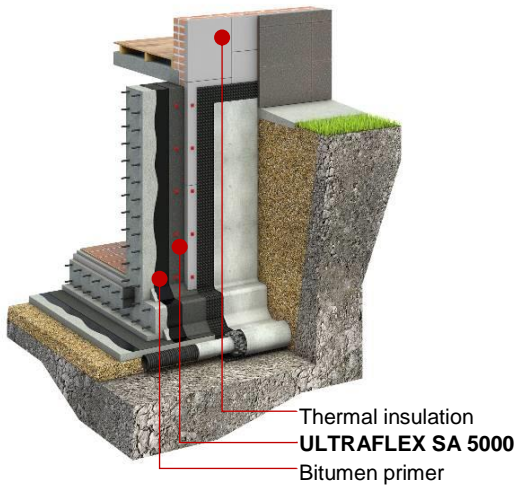

### FOUNDATION WITHOUT THERMAL INSULATION

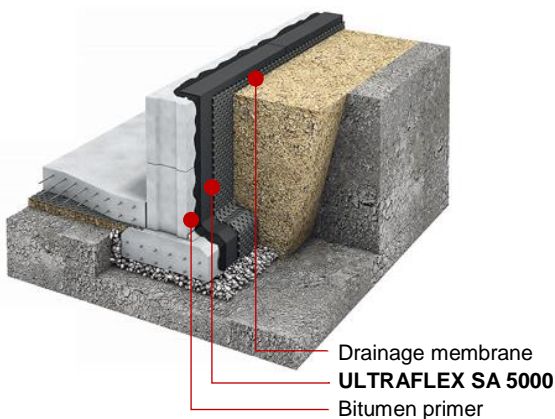

**1. CROSS LAMINATED SINGLE PLY HDPE FILM VERY STRONG** TO PROTECTS THE WATERPROOFING LAYER FROM MECHANICAL DAMAGE AND EXPOSURE TO CHEMICALLY AGGRESSIVE ENVIRONMENT

**2. SELF-ADHESIVE BITUMEN-POLYMER MIXTURE** THE HIGH ELASTICITY OF THIS LAYER ALLOWS TO KEEP THE WATERPROOFING INTACT IN THE EVENT OF A CRACK OR CRACKS IN THE FOUNDATION

**3. EASILY REMOVABLE PROTECTIVE SILICON FILM** RETAINS ADHESIVE PROPERTIES OF THE ADHESIVE LAYER

## ADVANTAGES

- COLD APPLIED SYSTEM: CAN BE USED WHERE THE STANDARD TORCH-ON APPLICATION IS NOT ALLOWED (WOOD, XPS). NO FLAME HAZARD, NO SMOKE, NO ODORS AND NOISE
- SINGLE LAYER – LOW LABOUR COST: FAST APPLICATION, NO NEED OF SPPECIAL EQUIPMENT AND SKILLS
- ECONOMICAL APPLICATION – NO NEED FOR GAS USAGE.
- CROSS LAMINATED HDPE FILM: GIVES MEMBRANE VERY HIGH DIMENSIONAL STABILITY AND PUNCTURE RESISTANCE
- ADVANCED SAFETY APPLICATION. THE MEMBRANE IS APPLIED WITHOUT USE OF FLAME AND THE PARTICULAR POINTS ARE TREATED WITH HOT AIR OR MASTICS BITUMEN ADHESIVES
- HIGH PERFORMANCE RUBBER BITUMEN COMPOUND: EXCELLENT ADHESION TO THE SUPPORT, CONTINUITY OF JOINT LAPPING, SELF-HEALING PROPERTIES (MINOR PERFORATION WILL AUTOMATICALLY HEAL)
- EXTRA GAS AND CHEMICAL RESISTANCE

## TECHNICAL DATA – ULTRAFLEX SA 5000

№		The indicator name	Test method	Unit of	Norm
1		Protection of the top side			<b>Cross laminated HDPE film</b>
2		Protection of the bottom side			<b>Releasing film</b>
3	MLV	Length	EN 1848-1	m	<b>≥ 20</b>
4	MLV	Width	EN 1848-1	m	<b>≥ 1</b>
5	Pass	Straightness	EN 1848-1	mm	<b>≤ 10 mm/5 m</b>
6	MDV	Mass per unit area	EN 1849-1	kg/m <sup>2</sup>	<b>1.5±0.25</b>
7	MDV	Thickness	EN 1849-1	mm	<b>1.5 ±0.1</b>
8		Puncture Resistance	ASTM E154	N	<b>≥ 220</b>
9	MLV	Cold flexibility, °C/ø 30 mm- upper face and lower face	EN 1109-1	°C	<b>≤ 25</b>
10	MLV	Peel strength	ASTM D903	N/m	<b>≥ 1400</b>
11	Pass	Water resistant within 24 hours, method A	EN 1928	10 kPa	<b>The lack of water penetration</b>
	Pass	Water resistant within 24 hours, method A	EN 1928	2 kPa	<b>The lack of water penetration</b>
12	MLV	Tear resistance	ASTM 1004	N/mm	<b>≥ 20</b>
13	MLV	Resistance to hydrostatic head	ASTM D5385	m	<b>60</b>
	MDV	Dimensional stability	EN 1107-1	%	<b>≤ 0.5</b>
	MDV	Tensile properties: Tensile Strength L / T	ASTM 412	N/mm	<b>≥ 4</b>
	MLV	Tensile properties: Elongation L / T	ASTM D412	%	<b>≥ 350 / ≥ 350</b>
14		External fire exposure	EN 13501-5 1187:2002, test 2	—	<b>F<sub>ROOF</sub></b>
15		External fire exposure	EN 13501-1	—	<b>Euroclass E</b>
16		Determination of water vapor transmission properties	EN 1931	—	<b>μ=20 000</b>
17		Dangerous substances		—	<b>Does not contain dangerous substances</b>
<b>Properties after artificial ageing/ EN 1296. 12 weeks at +70 °C</b>					
18	MDV	Flow resistance at elevated temperature , °C/2 h - upper face and lower face	EN 1110	°C	<b>NPD</b>
19	MDV	Cold flexibility, °C/ø 30 mm- upper face and lower face	EN 1109-1	°C	<b>NPD</b>
20	MDV		EN 1928	kPa	<b>NPD</b>

## INSTALLATION

SELF-ADHESIVE MEMBRANES IN COLD PERIODS TEND TO HARDEN RESULTING IN DECREASED ADHESION. LAYING THE SELF-ADHESIVE MATERIAL MUST BE WITH FAVORABLE CLIMATIC CONDITIONS I.E. DRY WEATHER AND TEMPERATURES AROUND +10 °C. AT TEMPERATURES BELOW +10 °C AND HIGH HUMIDITY THE ADHESION OF THE COAT CAN BE COMPROMISED AND THEREFORE IT WILL BE NECESSARY THE USE OF A HOT AIR TO RESTORE THE CHARACTERISTICS OF THE PRODUCT.

### GENERAL REQUIREMENTS:

- THE APPLICATION SURFACE MUST BE FREE OF ROUGHNESS, OIL, CLEAN TO ENSURE PROPER ADHESION OF THE PRODUCT.
- THE ROLLS SHOULD BE STORED INDOORS IN A DRY PLACE REPAIRED IN THEIR ORIGINAL PACKAGING AND TAKEN TO THE CONSTRUCTION SITE READY TO USE.
- KEEP THE ROLLS UPRIGHT AND DO NOT STACK THE PALLETS.
- YOU MUST APPLY A COAT OF BITUMINOUS PRIMER FOR THE REINFORCED CONCRETE SURFACES BEFORE APPLYING ULTRAFLEX SA 5000 SELF-ADHESIVE MEMBRANE.

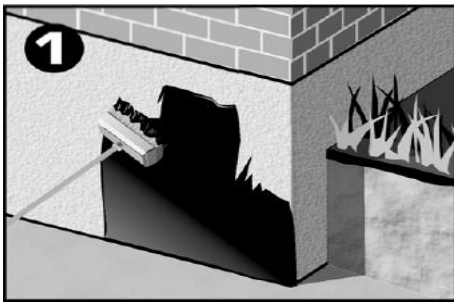

CLEAN AND PRIME THE SURFACE WITH BITUMEN PRIMER.

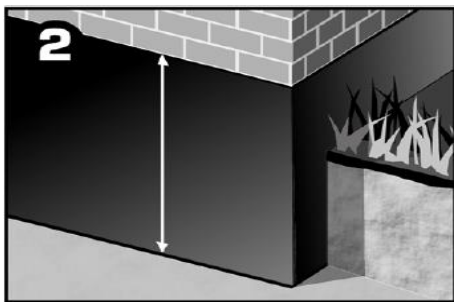

MEASURE THE HEIGHT OF THE FOUNDATION AND CUT THE MATERIAL THE REQUIRED LENGTH.

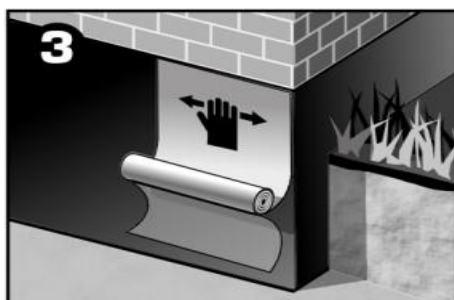

TO PUT ON TOP DOWN, REMOVING THE PROTECTIVE MEMBRANE SLOWLY UNWINDING THE COIL AND SMOOTH MATERIAL.

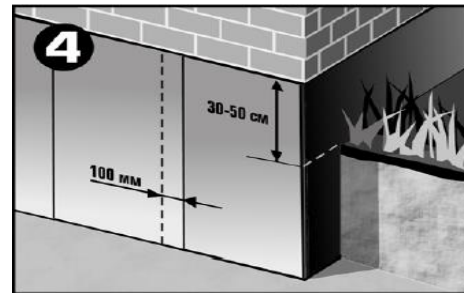

THE MATERIAL STARTS ABOVE THE GROUND LEVEL BY 30-50 CM LONGITUDINAL OVERLAP IS 100 MM, THE TRANSVERSE DIMENSIONS OF THE OVERLAP IS 150 MM.

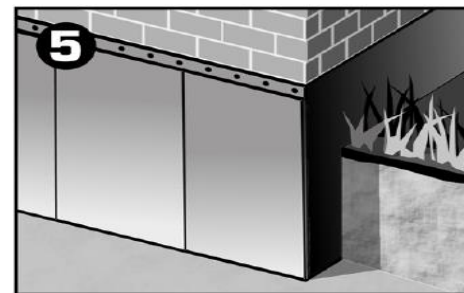

THE UPPER EDGE OF THE WATERPROOFING MATERIAL MUST BE FIXED IN THE BASEMENT OF THE PROFILED METAL RAIL EDGE.